

FONT: Avenir

COLORS & FINISHES:



White



PMS
533

ROOM NUMBERS: all are 3" x 6"



PART#
SRES-1000



NS SYMBOL
PART#
SRES-1001



ISA SYMBOL
PART#
SRES-1002



Hearing Impaired
PART#
SRES-1000



NS & ISA SYMBOL
PART#
SRES-1001



NS & Hearing
Impaired SYMBOL
PART#
SRES-1002



ISA & Hearing
Impaired SYMBOL
PART#
SRES-1002



NS, ISA & Hearing
Impaired SYMBOL
PART#
SRES-1002

IN ROOM PRODUCTS:

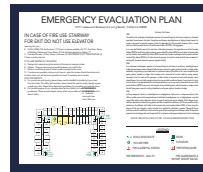

PRINTED IN ROOM EVACUATION
PART# SRES-1226
9.25" x 7.75"



MASTER SWITCH
PART# SRES-0330
4.75" x 2.125"



BALCONY WARNING
SIGN
PART# SRES-0326
3" x 3"



DO NOT HANG ON SPRINKLER
PART# 0331-2.5X2.5Delbeno
2.5" x 2.5"



DEADBOLT LEFT
PART# SC-0335-L
3" x .625"



DEADBOLT RIGHT
PART# SC-0335-R
3" x .625"



DOORBELL SWITCH
PART# SRES-0336
8.5" x 3.875"



DEPRESS SWITCH TIME
PART# SRES-0337
8.5" x 3.875"

DIRECTIONAL SIGNS



2 LINE DIRECTIONAL SIGN
PART# SRES-1102
11.875" x 4.875"

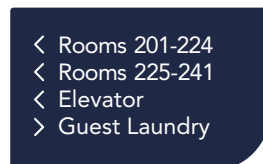

4 LINE DIRECTIONAL SIGN
PART# SRES-1104
11.875" x 7.375"

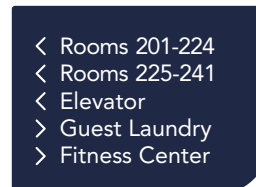

5 LINE DIRECTIONAL SIGN
PART# SRES-1105
11.875" x 8.625"

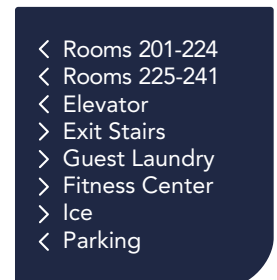

8 LINE DIRECTIONAL SIGN
PART# SRES-1108
11.875" x 12.875"

For a complete sign offering or quotation, please call your Brand Specialist.

5/2025